

5,000 GALLON (23 Cubic Metre) ELLIPTICAL TANK For agricultural use

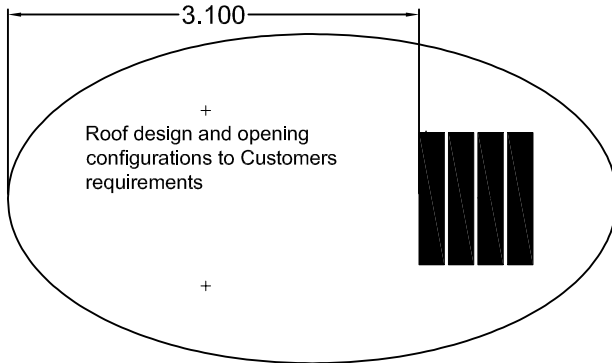

ROOF PLAN

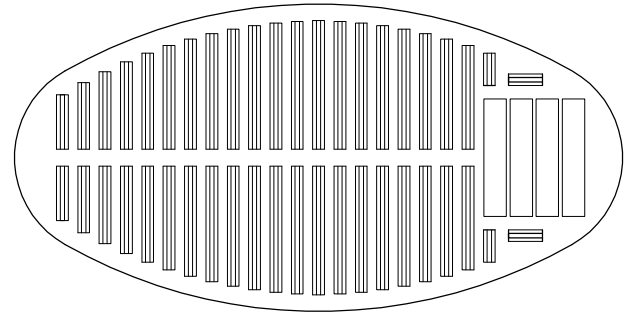

5000 Gallon Tank Slatted Roof Option

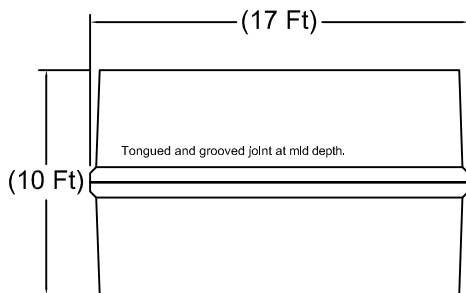

SIDE ELEVATION

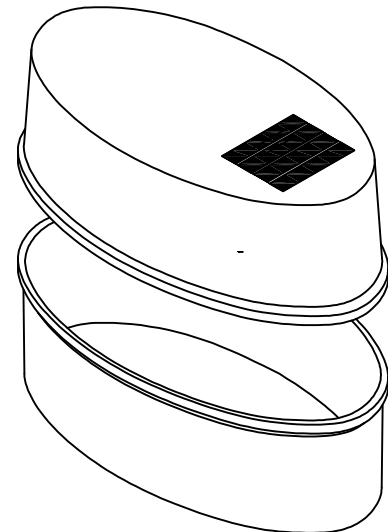

ISOMETRIC VIEW

- 1.) Select lid suitable to your application.
- 2.) Select inlet and outlets location if desired. Mark location and size of these on the drawing.
- 3.) Fill out the farm order confirmation form with drawings and post it to our office

Tanks require a level, well compacted base of CI 804, thickness of which will depend on site conditions typically 150mm thick (1/2 ft).

Lorry must be able to reverse to the edge of the excavation.

Tank is then installed by a crane at the rear of the lorry.

After installation we recommend filling the tank with water to prevent floatation until backfilling is complete. (only in high water table areas)

Site with a high watertable may require a hoop of concrete with rebar at the base of the tank to prevent floatation

Tank should be backfilled with material free of boulders and large stones.

Weight of tank 8.5 Tn Weight of lid 8.5 Tn

Solid lids can carry 5.8 Tn per axle wheel loads

Slatted lids can carry 4 Tn per axle wheel loads

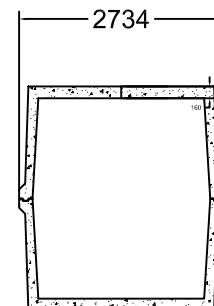

SHORT SECTION